

SAMPLE CYLINDER



SAHT-SC-10-S



SAHT-SC-15-S



SAHT-SC-25-S



SAHT-SC-30-S



SAHT-SC-50-S

상세설명

- Pressure and temperature rating: 1000psig
- -40℃ to 215℃
- SAHT-SC-10, 15, 25:
100, 150, 250cc with 1/4" F.NPT threads.
- SAHT-SC-30, 50:
300, 500cc with 3/8" F.NPT threads.

사양 및 주문번호

Model	A	Specification	B	Specification	Accessories
		Volume		Body Material	
SAHT-SC-A-B	10	100cc	H : Hastelloy-C M : Monel S : 316SS		* Needle Valves
	15	150cc			
	25	250cc			
	30	300cc			
	50	500cc			

SAMPLE CYLINDER

SAHT - SC - SAMPLE VOLUME - CYLINDER MATERIAL

SAMPLE CYLINDER

CYLINDER VOLUME

10 : 100cc
15 : 150cc
25 : 250cc
30 : 300cc
50 : 500cc

CYLINDER MATERIAL

S : SS316
H : HASTELLOY®
M : MONEL®

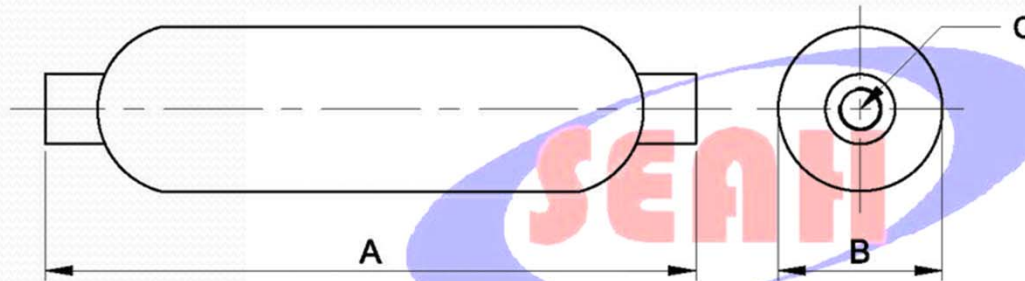

CYLINDER ORDERING No.	DIMENSION		
	A	B	C
SAHT - SC - 10 - S : 100 cc	187	Ø 47	1/4" F.NPT
SAHT - SC - 15 - S : 150 cc	242	Ø 47	1/4" F.NPT
SAHT - SC - 25 - S : 250 cc	326	Ø 47	1/4" F.NPT
SAHT - SC - 30 - S : 300 cc	288	Ø 60	3/8" F.NPT
SAHT - SC - 50 - S : 500 cc	385	Ø 60	3/8" F.NPT

DESIGN DATA

APPLIED CODE	-		
SIZE	SEE THE DIMENSION TABLE		
CAPACITY	SEE THE ORDERING TABLE		
PRODUCT STORED	SEAH HIGHTECH	MODEL	SAHT-SC-VOLUME-MATERIAL
PRESSURE	1000 psig	VOLUME	Reference Dimension Note.
TEMPERATURE	MINIMUM : -40 °C		MAXIMUM : 215 °C
TEST PRESSURE	WATER 50 KG/Cm ²	-	-
CORR. ALLOW.	10-25S: 6.35mm , 30-50S: 8.7 mm		
SHELL DESIGN	SEE THE BELOW DRAWING		
BODY DESIGN	DRAWING	NOZZLE TO SHELL CONN.	1/4" ~ 3/8" F.NPT
MATERIAL	BODY	: SS316	
	NOZZLE	: SS316	
	-	: -	
	-	: -	

ACCESSORIES

VESSEL FABRICATOR TO SUPPLY AND / OR INSTALL ITEMS INDICATED

- a. MOUNTING BRACKET b. VALVE
c. PRESSURE/ TEMP' GAUGE d. FITTING
e. MOUNTING BOLT

PAINTING BY FABRICATOR OTHERS: -

INSULATION : NO, SHELL : -

INSULATION COVER : -

NOTE : Permission to proceed does not constitute acceptance or approval of design data, calculations, analyses, test methods or materials developed or selected by the supplier and does not relieve supplier from full compliance with contractual obligations.

APPROVAL Nov.05,2006 J.S YOUN K.Y SON D.H PARK

REV. DESCRIPTION DATE REV'D CHECKED APP'D

SEAH HIGHTECH CO., LTD.
SEOUL, KOREA

TITLE
SAMPLE CYLINDER

SCALE NONE SCALE DRAWN DESIGN CHECK APPR.

PROJECTION -

DRAWING NO.
VP-SAHTP-SC-1 REV.

DATE Feb.10,2012 KI-YOUNG SON